

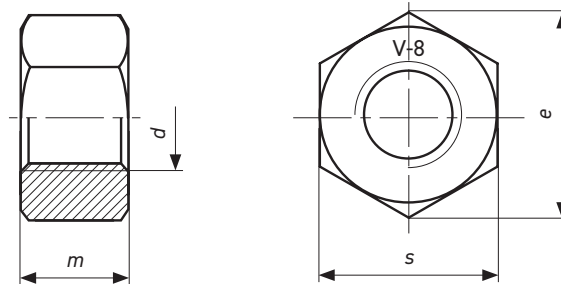

# HIGH HEX NUTS

ISO 4033 METRIC COARSE THREAD - ISO 8674 METRIC FINE THREAD

ISO 4033-8674    UNI -    DIN -



MATERIAL	STEEL	STAINLESS STEEL
MECHANICAL PROPERTIES	ACCORDING TO DIN 267-4 UNI 3740-4	ACCORDING TO ISO 3506-2
CLASS	<b>8/6S</b> <b>10</b>	<b>A2</b> <b>A4</b>
TOLLERANCES	ACCORDING TO ISO 4759-1 CAT A - B*	ACCORDING TO ISO 4759-1 CAT A-B*
AVAILABLE TREATMENT	Plain - White zinc plated or Yellow zinc plated according to RoHS - Hot dip galvanized - Other coatings on request	

<i>d</i>	<i>s</i>	<i>m</i>	<i>e</i> min	coarse thread	fine thread	 Kg
M 5	8	5	8,79	0,8		1,55
M 6	10	6	11,05	1		3,02
M 8	13	8	14,38	1,25	1	6,39
M 10	16	10	18,90	1,5	1/1,25	14,2
M 12	18	12	21,10	1,75	1,25/1,5	19,8
M 14	21	14	24,49	2	1,5	30,8
M 16	24	16	26,75	2	1,5	39,6
M 20	30	20	32,95	2,5	1,5	76,2
M 24	36	24	39,55	3	2	133
M 30	46	30	50,85	3,5	2	274
M 36	55	36	60,79	4		492,18

 Weight for 1000 pcs

(\* Tolerances are grade A until diameter 16, grade B over M16  
For stainless steel A2 products, multiply the weight values for 1,01, A4 by 1,013.  
The weights indicated are approximate. **Other sizes available on request.**



# HIGH HEX NUTS

ISO METRIC COARSE AND FINE THREAD

ISO    UNI    DIN  
-    5587    -

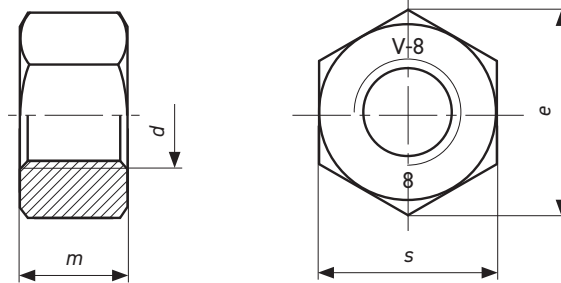

**MATERIAL**

**STEEL**

**MECHANICAL PROPERTIES**

ACCORDING TO DIN 267-4 UNI 3740-4

**CLASS**

**8/6S**

**TOLLERANCES**

ACCORDING TO ISO 4759-1 CAT A - B\*\*

**AVAILABLE TREATMENT**

Plain - White zinc plated or Yellow zinc plated according to RoHS - Other coatings on request

d	s	m	e min			Kg
				coarse thread	fine thread	
M 2	4	2	4,38	0,4		0,17
M 2,5	5	2,5	5,45	0,45		0,34
M 3	5,5	3	6,01	0,5		0,47
M 4	7	4	7,66	0,7		1,00
M 5	8	5	8,79	0,8		1,52
M 6	10	6	11,05	1		2,96
M 7	11	7	12,12	1		3,93
M 8	13	8	14,38	1,25		6,5
M 10	17	10	18,90	1,5	1	14,3
M 12	19	12	21,10	1,75	1,25	20,3
M 14	22	14	24,49	2	1,5	31,5
M 16	24	16	26,75	2	1,5	40,5
M 18	27	18	29,56	2,5	1,5	58,2
M 20	30	20	32,95	2,5	1,5	79,1
M 22	32	22	35,03	2,5	1,5	94,9
M 24	36	24	39,55	3	2	137
M 27	41	27	45,20	3	2	200
M 30	46	30	50,85	3,5	2	284
M 33	50	33	55,37	3,5	2	361
M 36	55	36	60,79	4	2	483
M 39	60	39	66,44	4	3	623
M 42	65	42	72,09	4,5	3	795
M 45	70	45	76,95	4,5	3	988
M 48	75	48	82,60	5	3	1220
M 52	80	52	88,25	5	3	1470
M 56	85	56	93,56	5,5	4	1770
M 60	90	60	99,21	5,5	4	2080
M 64	95	51	104,86	6	4	2450
M 68	100	54	110,51	6	4	2850
M 72	105	58	116,16	6	4	3310
M 76	110	61	121,81	6	4	3770
M 80	115	64	127,46	6	4	4265

Weight for 1000 pcs

Tolerances are grade A until diameter M16 grade B over M16.  
The weights indicated are approximate. **Other sizes available on request.**

